

Beaver® Mini-Blades

Innovative Solutions for Specialty Surgery

For over 75 years, Beaver® has been the industry leader for meeting the needs of specialty surgeons for a broad range of surgical procedures. Beaver's new Mini-Blades are manufactured using a proprietary grindless technology that yields consistent sharpness and blade geometry and are available in a variety of designs to meet all small incision and excision needs. Beaver® Mini-Blades are preassembled into a unique, patented tip, designed for safe assembly and ease of use. Each Mini-Blade® is color coded for easy identification.

Beaver® Mini-Blades*		
Description		Item #
	Beaver® 6400 Mini-Blade® Grindless, rounded tip, sharp on one side, green. 20 per box.	Beaver6400
	Beaver® 6600 Mini-Blade® Grindless, lamellar, angled 60 degrees, smooth undersurface, sharp all around, bevel up, black. 3 per box.	Beaver6600
	Beaver® 6610 Mini-Blade® Grindless, lamellar, straight, smooth undersurface, sharp all around, bevel up, black. 20 per box.	Beaver6610
	Beaver® 6700 Mini-Blade® Grindless, smaller alternative to #15 general blade, orange. 20 per box.	Beaver6700
	Beaver® 6900 Mini-Blade® Grindless, straight, sharp all around, 180 degree cutting surface, double bevel blade, blue. 20 per box.	Beaver6900
	Beaver® 6910 Mini-Blade® Grindless, angled 60 degrees, sharp all around, 180 degree cutting surface, double bevel blade, blue. 6 per box.	Beaver6910

* Patent D636082. Additional US and International patents pending.

For ordering information call:
+44 1865 601 256 Option 3
or visit www.beaver-visitec.com

 **Beaver Visitec**
Keeping Your Vision in Sight

Beaver® Mini-Blades

Innovative Solutions for Specialty Surgery

Cross Reference Part List

Current Cat. No	New Cat. No
376400	Beaver6400
376600	Beaver6600
376610	Beaver6610
376700	Beaver6700
376900	Beaver6900
376910	Beaver6910

Beaver® Mini-Blades can be used with the following Beaver handles, no collet required:

Description	Item #
Round, knurled, stainless, 13.0 cm L x .50 cm D	371350
Round, knurled, stainless, 13.0 cm L x .66 cm D	371360
Round, 18.0 cm L x .4 cm D No chuck collet included.	371394
Round, 21.0 cm L x .4 cm D No chuck collet included.	371395
Round, knurled, stainless, 10.2 cm L x .64 cm D	371410
Round, knurled, stainless, 10.0 cm L x .50 cm D	374310
Round, knurled, stainless, 5.0 cm L x .50 cm D	374311
Round, knurled, stainless, 7.5 cm L x .50 cm D	374312
Round, knurled, stainless, 15.5 cm L x .50 cm D	374320
Hex, stainless, 10.0 cm L x .50 cm D	374330
Hex, stainless, 15.5 cm L x .50 cm D	374340

Directions for Assembly

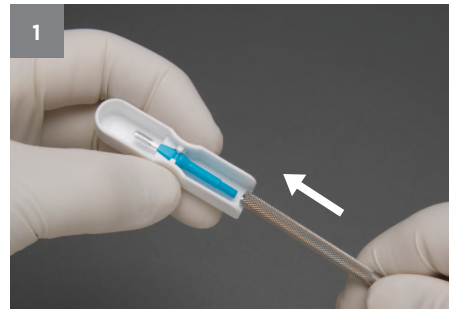

Hold the Beaver® Mini-Blade® tray between thumb and pointer finger.

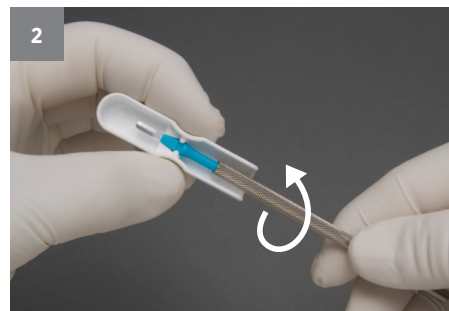

Thread the Beaver® handle in a clockwise motion, onto the threaded tip.



Continue to thread handle until the thread is fully engaged and the Mini-Blade® is released from the tray clips.

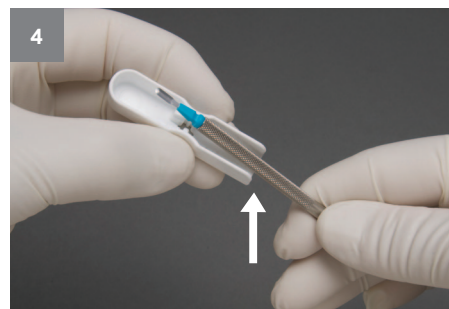

Lift to remove Beaver® Mini-Blade® from tray.

Instructional assembly video on www.beaver-visitec.com



Beaver-Visitec International Ltd

Centurion Court - 85c Milton Park
Abingdon, Oxfordshire - OX14 4RY UK
Tel. : +44 1865 601 256 - Fax : +44 1865 595 761
www.beaver-visitec.com